

# Vivid Sash Limiter

## Casement and Awning Field Applied Instruction

---

**ABSTRACT:** The following instruction is intended for Vivid Casement and Awning windows built September 29, 2025 or later. The following instruction will show you how to apply sash limiter(s) on Vivid casements and awnings. Sash limiters are used on casement windows 24" wide or greater and awning windows 24" wide or greater.

---

### Sash Limiter Kit Includes:

- Limiter Arm
- Sash Track
- 2 - #8 x 3/8" T20 Torx Tamper-proof PH Type AB Screw
- 2 - #8 x 11/16" T20 Torx Tamper-proof PH Type AB Screw
- Template
- Jig/Shim
- T-20 tamper resistant bit with driver

*NOTE: If two limiters are needed, you will need twice as many parts*

*NOTE: Removing the casement and awning sash is not required but may make locating and drilling holes easier. Refer to the Vivid Installation Instructions for details on removing sash.*

*NOTE: Images are for illustrative purposes only and may not reflect your actual unit.*

---

### Tools Needed:

- Scissor or knife
- Drill with a 7/64" bit
- Awl
- Screwdriver with bit adapter

---

### Design Limitations:

*For Casement that require one sash limiter, apply in the lower jamb. For Awning that require one sash limiter, apply to the exterior right-hand side.*

Unit Type	Frame Height	Number of Sash Limiters
Casement	16" – 71.5"	1
Casement	71.501" – 95.5"	2
Awning	16" – 53"	1
Awning	53" - 71.5"	2

## Installing the Sash Limiter

1. Cut out the frame template and attach to the frame using the instructions on the template to locate the template.
2. Use an awl to mark the fastener hole locations on the frame. [See Figure 1](#) and [Figure 2](#).



Figure 1



Figure 2

3. Remove the template. Use a 7/64" (3) drill bit to pre-drill the hole locations. [See Figure 3](#). Be sure not to drill deeper than 7/16".

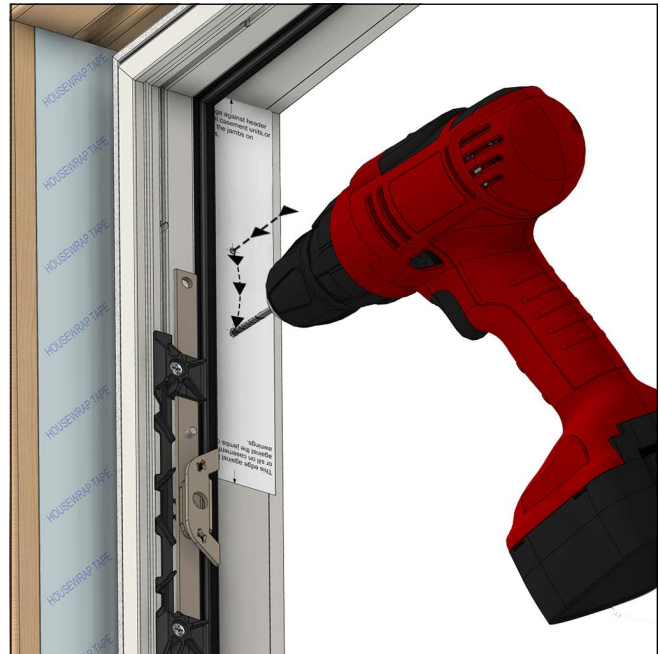

Figure 3

4. Align the sash limiter to the pre-drilled holes. Attach the limiter arm to the frame with the #8 x 3/8" T20 Torx tamper-proof PH Type AB screws provided. Use a screwdriver or drill to tighten. DO NOT OVERTIGHTEN! [See Figure 4](#).

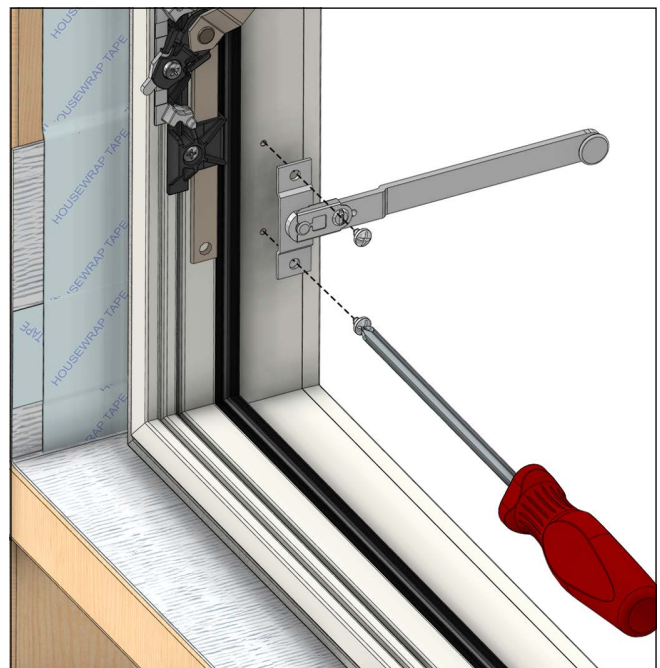

Figure 4

## Installing the Sash Limiter Track

1. Align the provided plastic jig/shim to the side of the sash to locate where the pre-drilled holes will be placed. See Figure 5 and Figure 6.

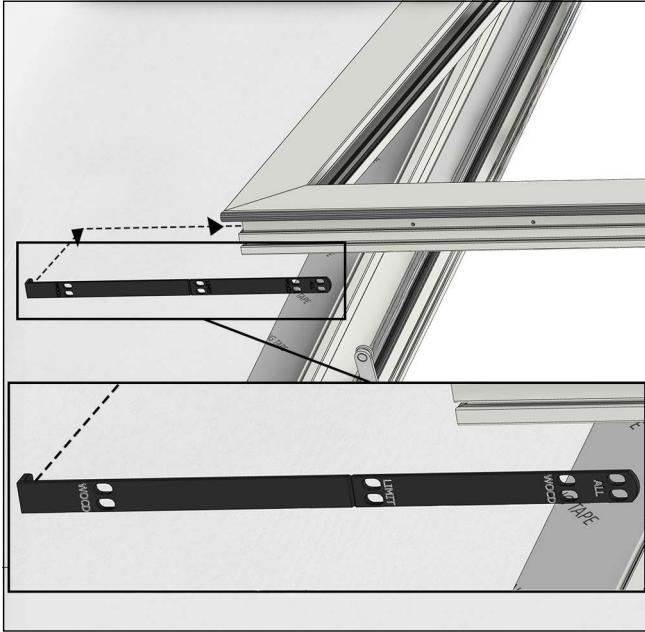

Figure 5 Awning



Figure 6 Casement

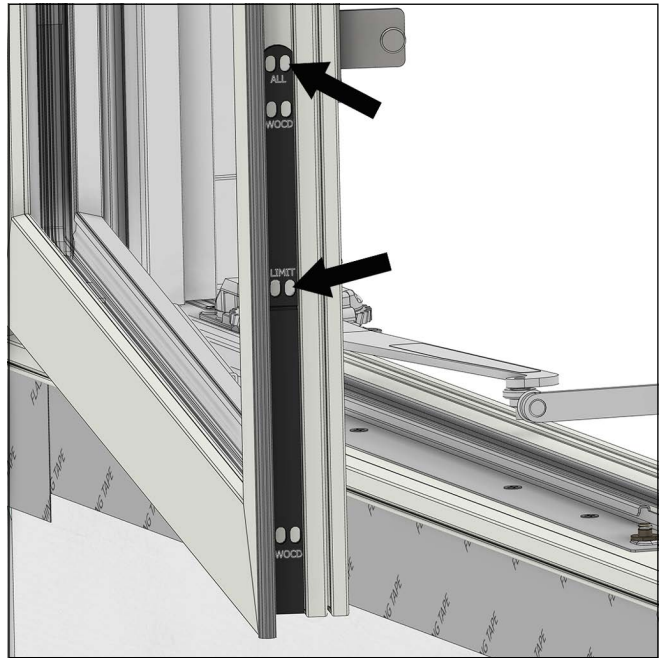

Figure 7

2. Use a 7/64" (3) drill bit to pre-drill the hole locations closest to the interior labeled ALL and LIMIT. See Figure 8. Be sure not to drill deeper than 7/16".

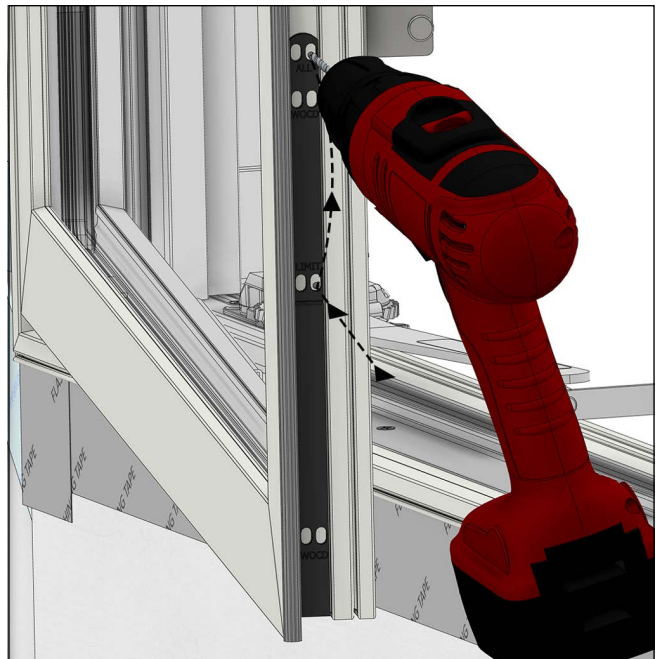

Figure 8 Pre-drilling Sash Holes



3. Line up your provided sash track to the unit. Place it over the plastic jig. [See Figure 9.](#)



**Figure 9** Lining Up Track

4. Attach the track to the sash with the #8 x 11/16" T20 torx tamper-proof PH type AB screw provided. Use a screwdriver to tighten. **DO NOT OVERTIGHTEN!** [See Figure 10](#)



**Figure 10** Installing Top Screw

5. Insert the limiter arm into the bottom of the track [See Figure 12](#) and [Figure 12.](#)



**Figure 11** Inserting Limiter Arm



**Figure 12** Inserting Limiter Arm

6. Attach the bottom screw to the sash with the #8 x 11/16" T20 torx tamper-proof PH type AB screw provided. Use a screwdriver or drill to tighten. DO NOT OVERTIGHTEN! See Figure 13.

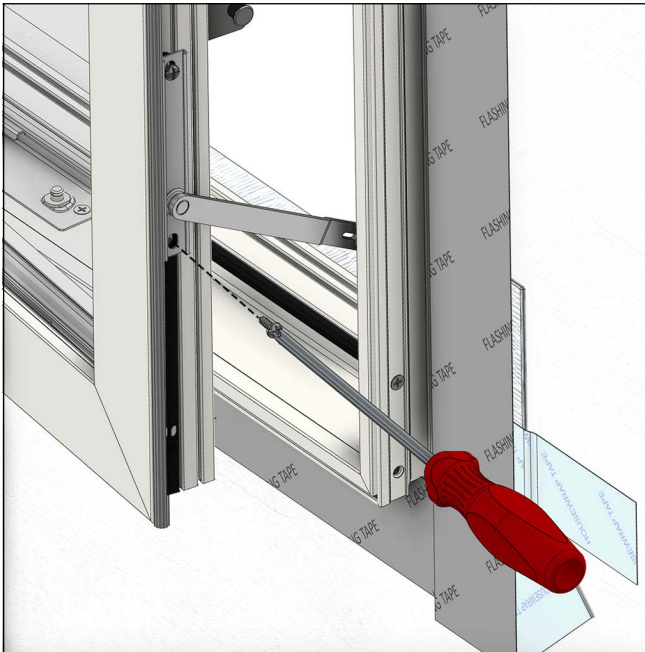

Figure 13 Installing Bottom Screw

7. Remove the bottom of the jig by pulling it upwards and breaking it off. See Figure 15 - Figure 16.

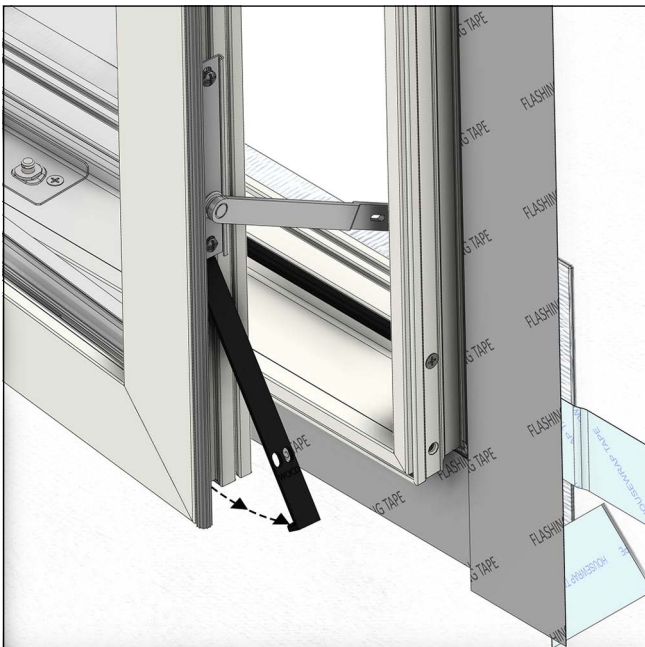

Figure 14 Removing lower section of plastic jig

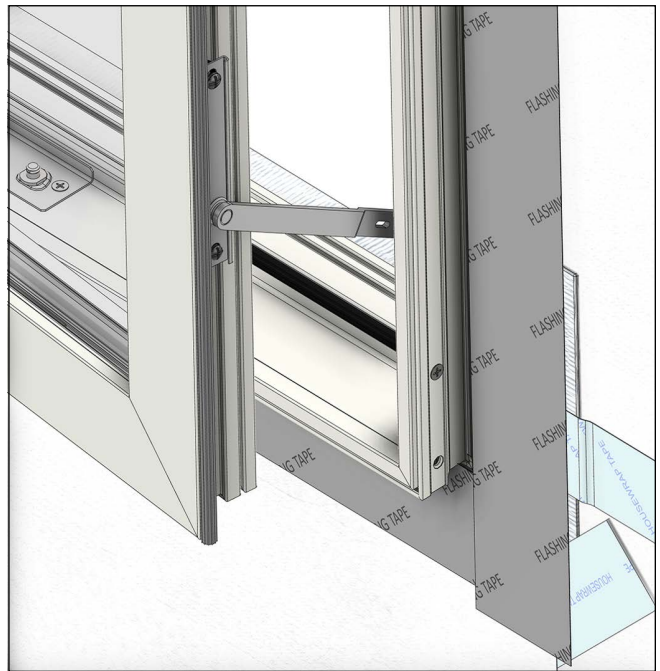

Figure 15 Casement Limiter Complete

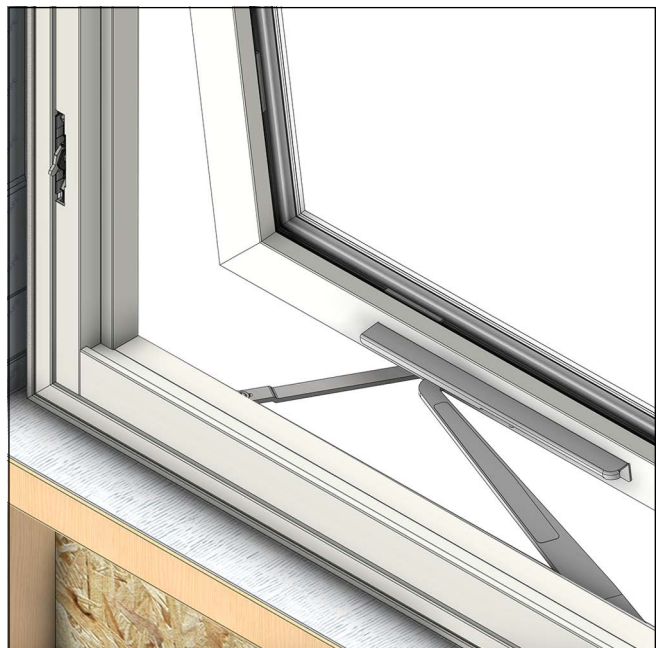

Figure 16 Awning Limiter Complete

# Template

