



Elevate Outswing French Door G3

Replacement
Parts

Specifications and technical data are subject to change without notice.

Numbers listed in () parentheses are metric equivalents in millimeters rounded to the nearest whole number.

Suggested fasteners are not included and must be ordered separately.

Illustrations are not to scale.

Contents

Product History.....	2
Part Identification - Two Panel Operator XX.....	3
Part Identification - Three Panel Operator OXO	4
Part Identification - Two Panel OXL/XOR	5
Part Identification - Two Panel XOL/OXR	6
Part Identification - One Panel Operator X	7
Part Identification - Single Panel Stationary O	8
Part Identification - Two Panel Stationary OO	9
Handles	10
Hinge Handling Location	16
Hinges.....	17
Locking Hardware	18
Miscellaneous Parts	26
Fasteners.....	28
Aluminum Parts - Configured Parts in OMS	31
Vinyl Parts.....	32
Vinyl Parts - Configured Parts in OMS.....	33
Wood Parts.....	34
Wood Parts - Configured Parts in OMS	35
Weather Strip - Configured Parts in OMS.....	36

Produced	Unit Type	Features and Changes
2024	Outswing French Door G3	06/24/2024: Introduced Outswing French Door G3. See Product Bulletin 942 for additional information.
2025	Outswing French Door G3	06/30/2025: Introduced High Performance and IZ3 Certified doors. 10/27/2025: LowE2 with ERS and Laminated glass added. See Product Bulletin 991 for more information. The Stainless Steel Perimeter Bar option in OMS updated the description from “Stainless” to “Silver”. See Product Bulletin 990 for more information.

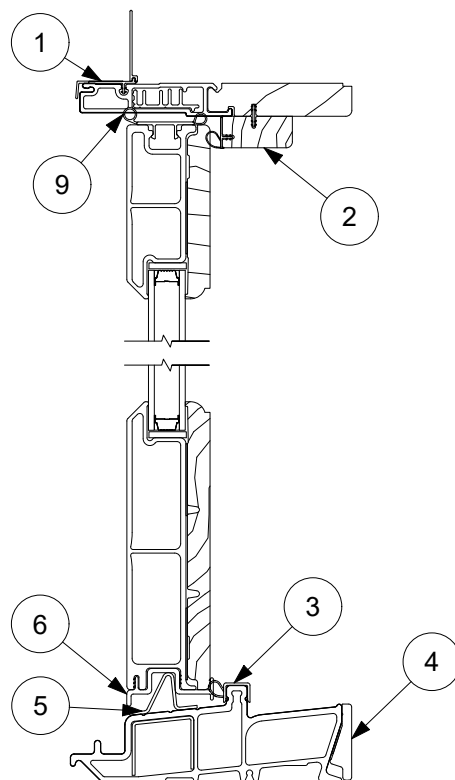

Head Jamb and Sill Detail

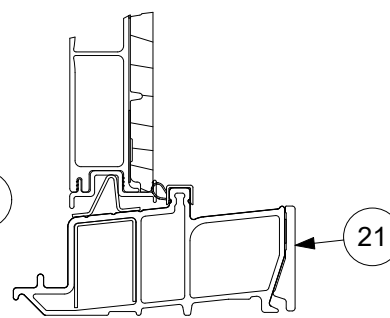

HP/IZ3 Sill Detail

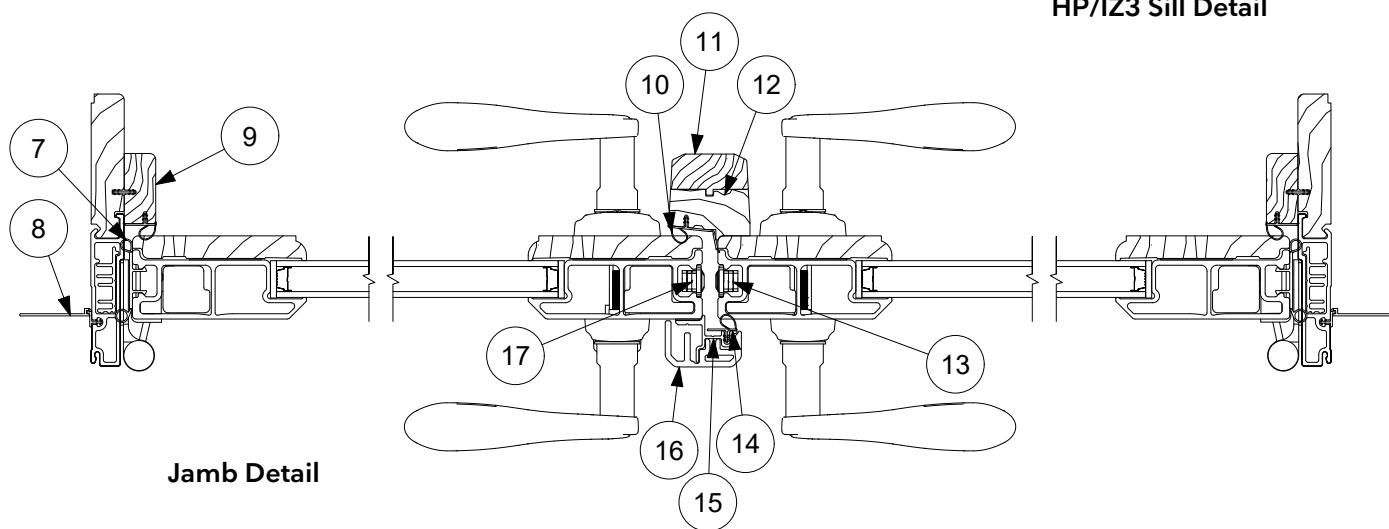

Jamb Detail

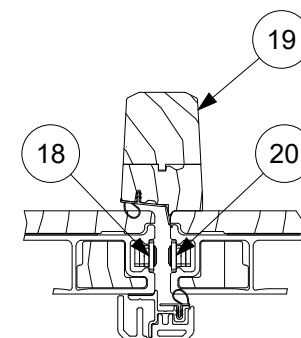

HP/IZ3

1. Head Jamb Nailing Fin/Drip Cap, V119
2. Panel Stop, Head Jamb
3. Sill Weather Strip, V2026
4. Sill Liner, V03375
5. Sill Retainer, (Stationary only)
6. Panel Sweep, V03376
7. Weather Strip, Eurogroove, V03410
8. Hinged Nailing Fin, V104
9. Panel Stop, Jamb
10. Astragal Weather Strip, Interior, V03386
11. Astragal Cap Interior, W14384
12. Astragal Base, Interior, W14383
13. Inactive Multi-Point
14. Astragal Weather Strip, Exterior, V2800
15. Astragal Base, Exterior, A1432
16. Astragal Cap, Exterior, A1464
17. Active Multi-Point
18. Active Multi-Point, HP/IZ3
19. Astragal Cap, Interior, HP/IZ3, W14578
20. Inactive Multi-Point, HP/IZ3
21. Sill Liner, HP/IZ3, V03481

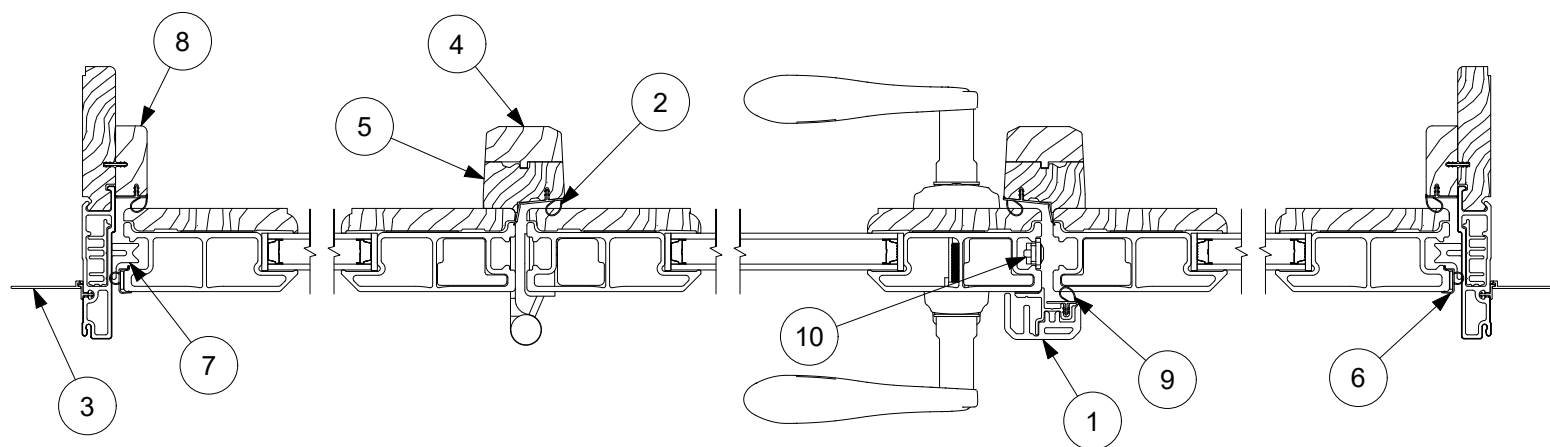

Jamb Detail

1. Astragal Cap, Exterior, A1464
2. Astragal Weather Strip, Interior, V03386
3. Hinged Nailing Fin, V104
4. Astragal Cap Interior, W14384
5. Astragal Base, Interior, W14383
6. Locking/Stat Stile Weather Strip, Panel, V1556
7. Stationary Jamb Retainer
8. Panel Stop, Jamb
9. Astragal Weather Strip, Exterior, V2800
10. Active Multi-Point

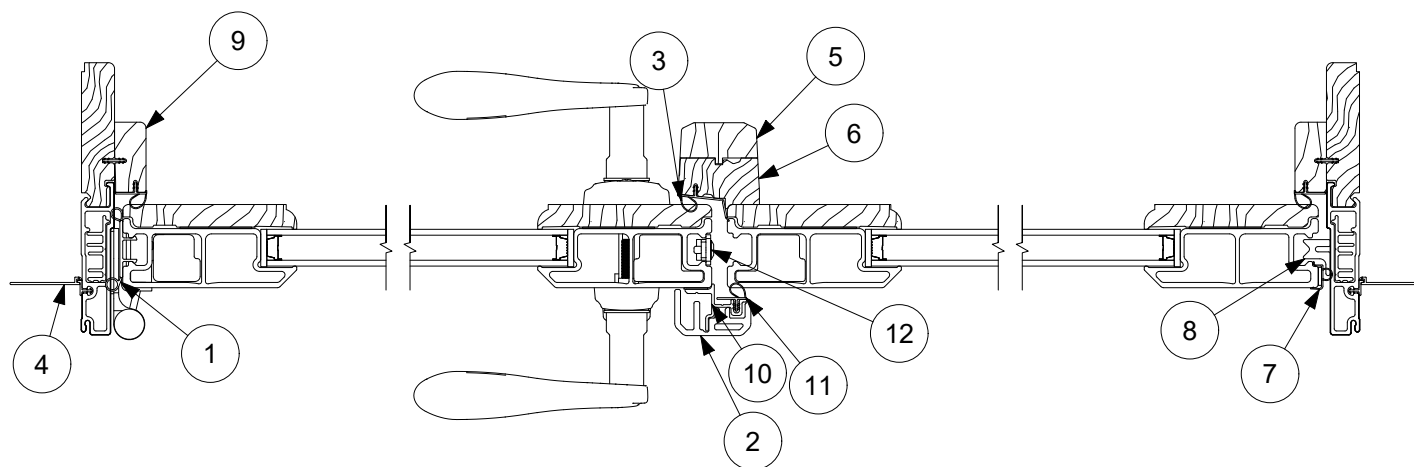

Jamb Detail

1. Weather Strip, Eurogroove, V03410
2. Astragal Cap, Exterior, A1464
3. Astragal Weather Strip, Interior, V03386
4. Hinged Nailing Fin, V104
5. Astragal Cap Interior, W14384
6. Astragal Base, Interior, W14383
7. Locking/Stat Stile Weather Strip, Panel, V1556
8. Stationary Jamb Retainer
9. Panel Stop, Jamb
10. Astragal Base, Exterior, A1432
11. Astragal Weather Strip, Exterior, V2800
12. Active Multi-Point

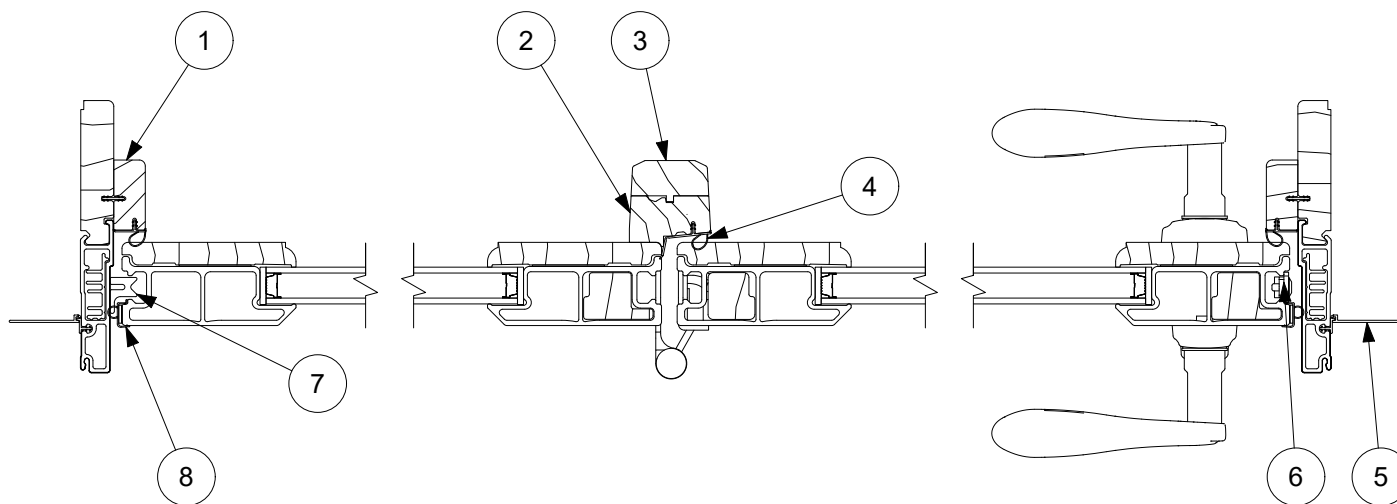

Jamb Detail

1. Panel Stop, Jamb
2. Astragal Base, Interior, W14383
3. Astragal Cap Interior, W14384
4. Astragal Weather Strip, Interior, V03386
5. Hinged Nailing Fin, V104
6. Active Multi-Point
7. Stationary Jamb Retainer
8. Locking/Stat Stile Weather Strip, Panel, V1556

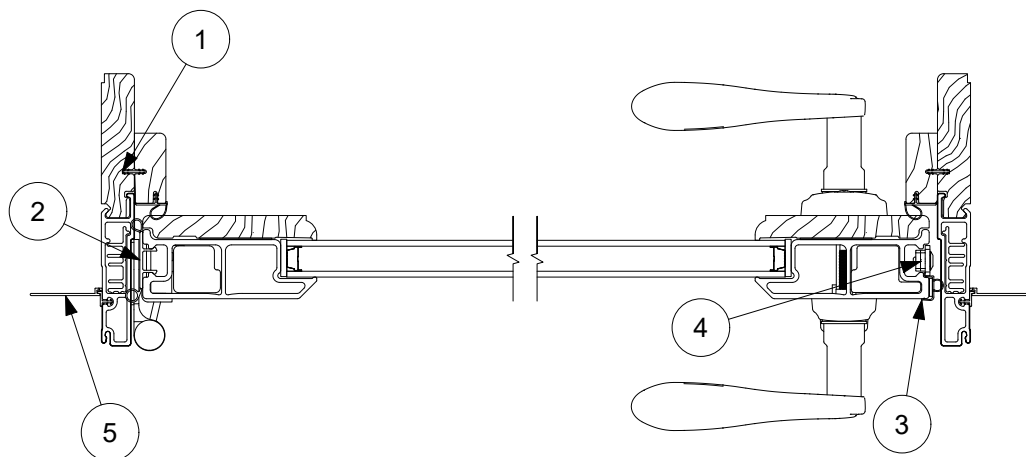

Jamb Detail

1. Panel Stop, Jamb
2. Weather Strip, Eurogroove, V03410
3. Locking/Stat Stile Weather Strip, Panel, V1556
4. Active Multi-Point
5. Hinged Nailing Fin, V104

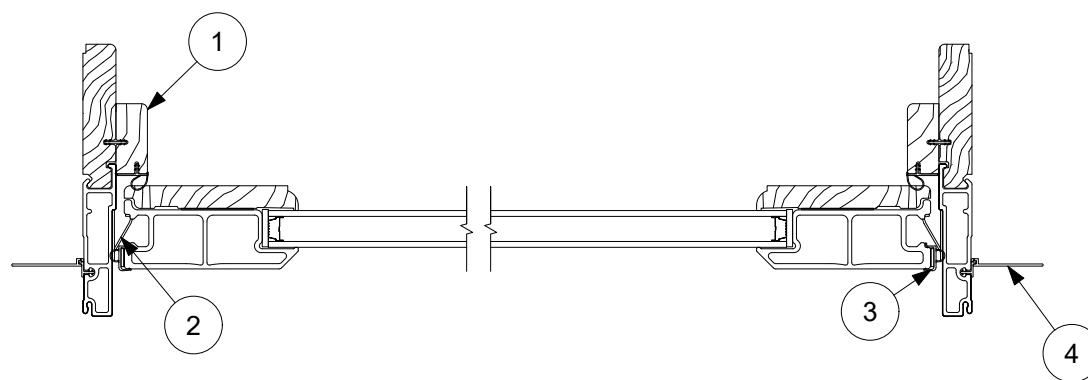

Jamb Detail

1. Panel Stop, Jamb
2. Stationary Panel Clip
3. Locking/Stat Stile Weather Strip, Panel, V1556
4. Hinged Nailing Fin, V104

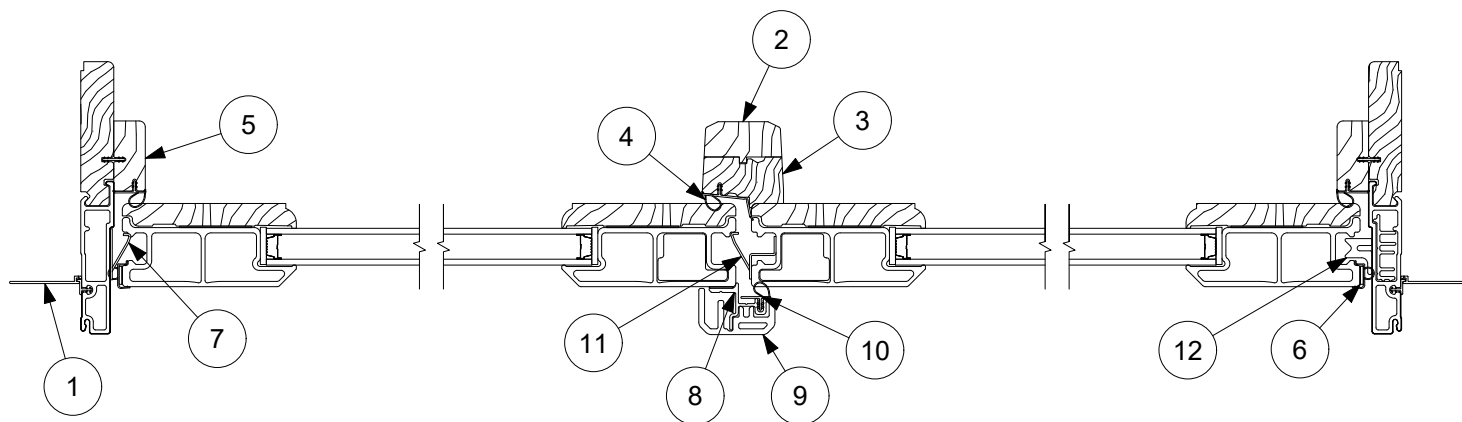

Jamb Detail

1. Hinged Nailing Fin, V104
2. Astragal Cap Interior, W14384
3. Astragal Base, Interior, W14383
4. Astragal Weather Strip, Interior, V03386
5. Panel Stop, Jamb
6. Locking/Stat Stile Weather Strip, Panel, V1556
7. Stationary Panel Clip
8. Astragal Base, Exterior, A1432
9. Astragal Cap, Exterior, A1464
10. Astragal Weather Strip, Exterior, V2800
11. Stationary Panel Clip, OO
12. Stationary Jamb Retainer

Cambridge Primary Handle Set, Exterior

Includes:

- 1 - Exterior handle
- 1 - Exterior escutcheon
- 1 - Hardware gasket
- 1 - Z Clip
- 1 - Z Clip screw
- 1 - Keyed cylinder
- 2 - Keys

NOTE: Escutcheon width 1.350”

Color	XX-R, X-R	XX-L, X-L
Almond Frost	11868026	11868021
Stone White	11868031	11868019
Brass PVD	11868028	11868023
Satin Nickel PVD	11868029	11868024
Oil Rubbed Bronze PVD	11868030	11868025
Matte Black	11868069	11868068

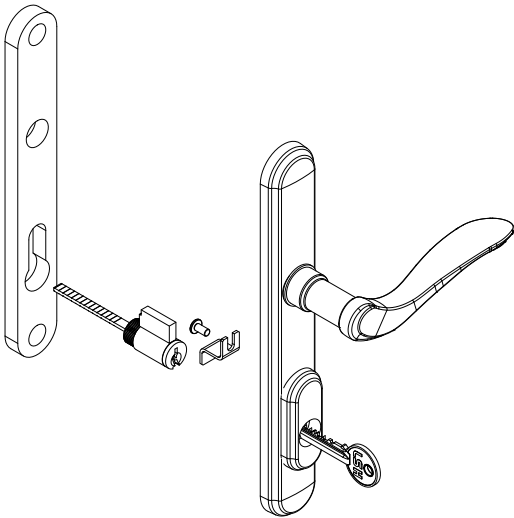

XX-L X-L shown

Cambridge Primary Handle Set, Interior

Includes:

- 1 - Interior handle
- 1 - Interior escutcheon
- 1 - Spring cassette
- 1 - Spindle
- 1 - Thumb turn
- 2 - M5 x 58 machine screws

Color	XX-R, X-R	XX-L, X-L
Almond Frost	11869106	11869101
Stone White	11869210	11869209
Brass PVD	11869108	11869103
Satin Nickel PVD	11869109	11869104
Oil Rubbed Bronze PVD	11869110	11869105
Matte Black	11869149	11869169

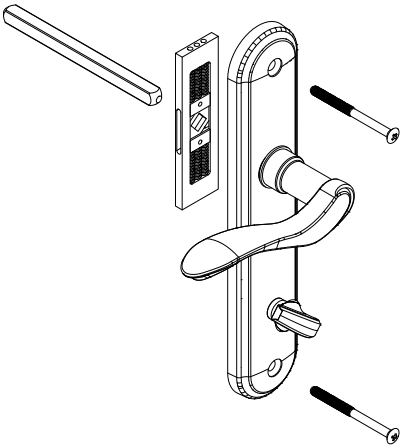

XX-L, X-L shown

Cambridge Secondary Handle Set, Exterior

Includes:

- 1 - Exterior handle
- 1 - Exterior escutcheon
- 1 - Hardware gasket

NOTE: Escutcheon width 1.350"

Color	XX-L	XX-R
Almond Frost	11868046	11868041
Stone White	11868037	11868032
Brass PVD	11868048	11868043
Satin Nickel PVD	11868049	11868044
Oil Rubbed Bronze PVD	11868050	11868045
Matte Black	11868071	11868070

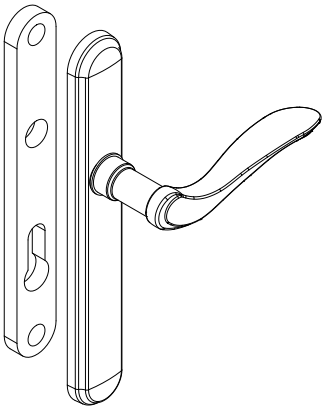

XX-L shown

Cambridge Secondary Handle Set, Interior

Includes:

- 1 - Interior handle
- 1 - Interior escutcheon
- 1 - Spring cassette
- 1 - Spindle
- 2 - M5 x 58 machine screws

Color	XX-L	XX-R
Almond Frost	11869126	11869121
Stone White	11869227	11869222
Brass PVD	11869128	11869123
Satin Nickel PVD	11869129	11869124
Oil Rubbed Bronze PVD	11869130	11869125
Matte Black	11869159	11869150

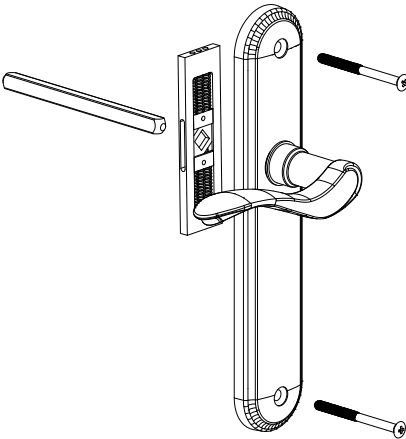

XX-R shown

Northfield Primary Handle Set, Exterior

Includes:

- 1 - Exterior handle
- 1 - Exterior escutcheon
- 1 - Hardware gasket
- 1 - Z Clip
- 1 - Z Clip screw
- 1 - Keyed cylinder
- 2 - Keys

Color	PN
Almond Frost	11869161
Stone White	11869162
Brass PVD	11869163
Satin Nickel PVD	11869164
Oil Rubbed Bronze PVD	11869165
Matte Black	11869168

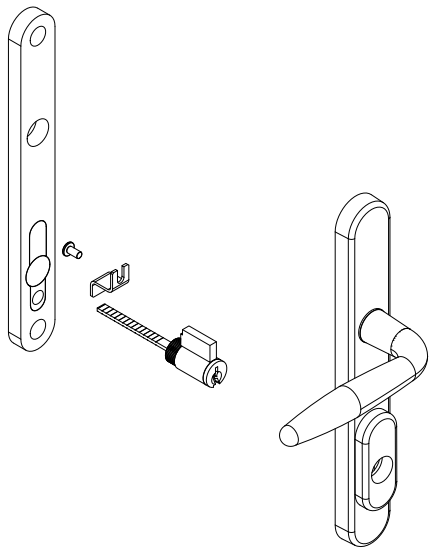

Northfield Primary Handle Set, Interior

Includes:

- 1 - Interior handle
- 1 - Interior escutcheon
- 1 - Spring cassette
- 1 - Spindle
- 1 - Thumb turn
- 2 - M5 x 58 machine screws

Color	PN
Almond Frost	11869151
Stone White	11869152
Brass PVD	11869153
Satin Nickel PVD	11869154
Oil Rubbed Bronze PVD	11869155
Matte Black	11869160

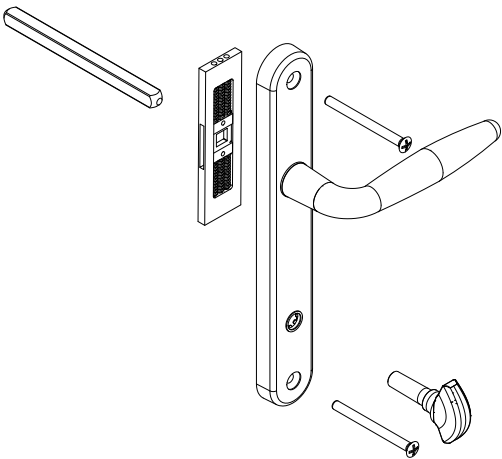

Northfield Secondary Handle Set, Exterior

Includes:

- 1 - Exterior handle
- 1 - Exterior escutcheon
- 1 - Handle gasket

Color	PN
Almond Frost	11869181
Stone White	11869182
Brass PVD	11869183
Satin Nickel PVD	11869184
Oil Rubbed Bronze PVD	11869185
Matte Black	11869190

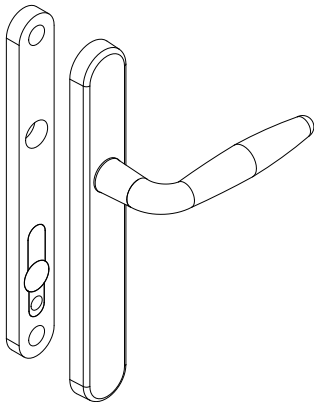

Northfield Secondary Handle Set, Interior

Includes:

- 1 - Interior handle
- 1 - Interior escutcheon
- 1 - Spring cassette
- 1 - Spindle
- 2 - M5 x 58 machine screws

Color	PN
Almond Frost	11869171
Stone White	11869172
Brass PVD	11869173
Satin Nickel PVD	11869174
Oil Rubbed Bronze PVD	11869175
Matte Black	11869180

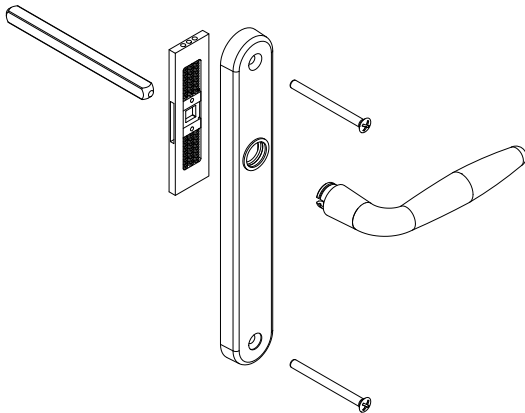

Hardware Gasket

PN
11860969



Spring Cassette

PN
11860960

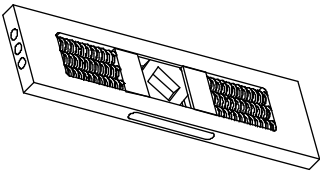

Escutcheon Plate Screws

NOTE: 1-M5 x 58 machine screw

Color	PN
Brass PVD	11805189
White	11805188
Almond Frost	11805187
Satin Nickel PVD	11805190
Oil Rubbed Bronze PVD	11805191
Matte Black	11805143

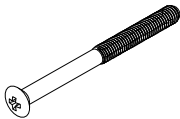

Z-Clip

Includes:

2 - Fasteners

NOTE: Used on both Cambridge and Northfield hardware

PN
11860967

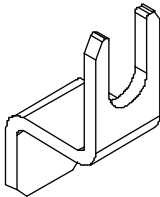

Replacement Washers

PN
11860964

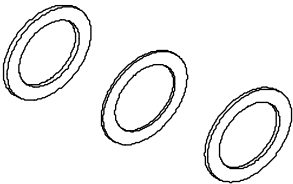

Split Ring

PN
11860966

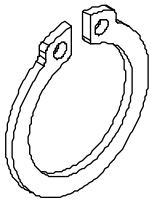

Keyed Cylinder with Keys

Includes:

2 - Keys

NOTE: Schlage cylinder
NOTE: For keyed alike cylinders, please contact your Marvin representative. Please supply the original order number if possible.

Color	PN
Brass	11860963

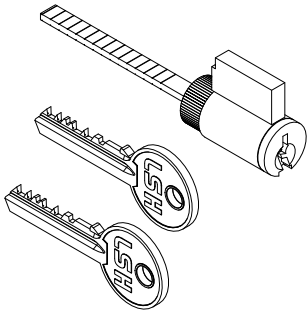

Spindle

PN
11860962

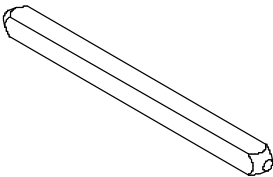

Clip, Thumb Turn

PN
11860972

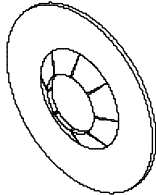

NOTE: Always view units from the exterior for handing.
H=Hinge location

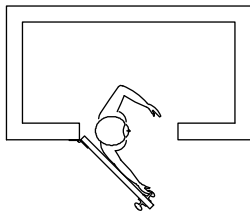

RH Outswing

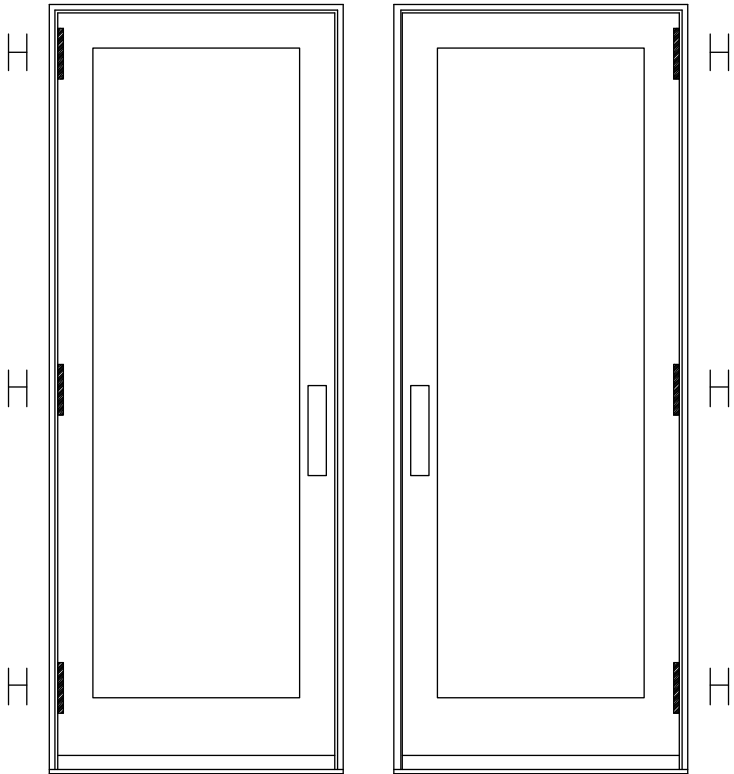

X-RH Outswing
 This panel uses the right hand hinge

X-LH Outswing
 This panel uses the left hand hinge

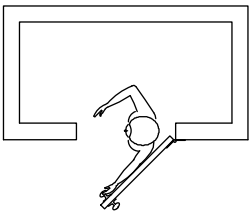

LH Outswing

Adjustable Hinge

NOTE: If replacing a hinge, 1 Hinge Gasket is needed

Color	X-R, XX-R	X-L, XX-L
Goldtone	11861801	11861802
Gray	11861803	11861804
Almond Frost	11861809	11861810
Cashmere	11861823	11861824
Pebble	11861819	11861820
Dark Brown	11861805	11861806
White	11861807	11861808
Ebony	11861817	11861818
Brass PVD	11861811	11861812
Satin Nickel PVD	11861813	11861814
Oil Rubbed Bronze PVD	11861815	11861816

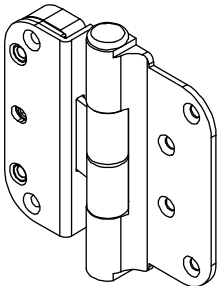

RH shown

Suggested Fasteners	
2 - 5/8" Phillips Flat Head Screw needed if panel is hinged from frame	
Color	EA PN
Stainless Steel	11805180
Stone White	11805155
Dark Brown*	11805156
Brass/Lacquer	11805153
Pebble	11805157
Cashmere	11805146
Almond Frost	11885156
Painted Gold	11805159
Painted Silver	11805158

Suggested Fasteners	
6 - 2 1/2" Phillips Flat Head Screw needed if panel is hinged from frame	
8 - 2 1/2" Phillips Flat Head Screw needed if panel is hinged from panel	
Color	EA PN
Stainless Steel	11800648
Stone White	11805163
Dark Brown*	11805164
Brass/Lacquer	11805165
Pebble	11805175
Cashmere	11805147
Almond Frost	11885164
Painted Gold	11805161
Painted Silver	11805162

*Oil Rubbed Bronze and Ebony hinges use Dark Brown fasteners

Hinge Spacer Block

NOTE: Only used when panel is hung from another panel

Color	PN
Black	11860209

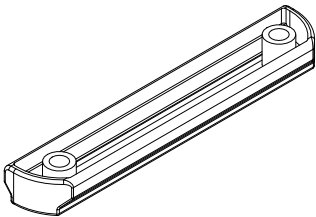

Hinge Gasket

PN
11705150

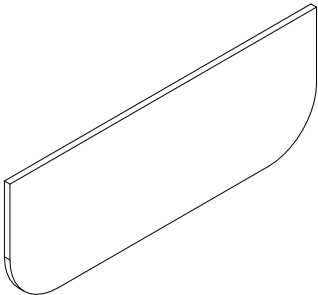

Active Multi-Point

Includes:

- 1 - Lock assembly with faceplate, deadbolt, latch and shoot bolts
- 11 (13 on 8/0) - #8 x 1 1/2" Phillips flat head Stainless Steel screws
- 2 - #8-15 x 2 1/2" Type AT/F, 2/3 thread, Stainless Steel screws

CN	Color	PN
6-5	Stainless Steel	11896701
6-8		11896702
7-0		11895700
8-0		11896703

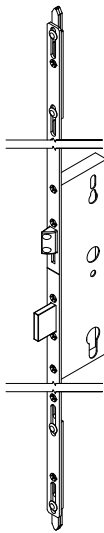

Special Size Active Multi-Point

Includes:

- 1 - Lock assembly with faceplate, deadbolt, latch and lower shoot bolts
- 1 - Top shoot bolt extension
- 12 - #8 x 1 1/2" Phillips flat head Stainless Steel screws
- 2 - #8-15 x 2 1/2" Type AT/F, 2/3 thread, Stainless Steel screws

Color	PN
Stainless Steel	11895701

Inactive Multi-Point

Includes:

- 1 - Lock assembly with faceplate and shoot bolts
- 11 (13 on 8/0) - #8 x 1 1/2" Phillips flat head Stainless Steel screws

CN	Color	PN
6-5	Stainless Steel	11896704
6-8		11896705
7-0		11894700
8-0		11896706

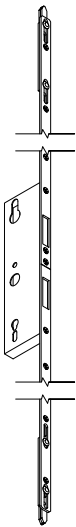

Special Size Inactive Multi-Point

Includes:

- 1 - Lock assembly with faceplate and lower shoot bolts
- 1 - Top shoot bolt extension
- 12 - #8 x 1 1/2" Phillips flat head Stainless Steel screws

Color	PN
Stainless Steel	11894701

Active Multi-Point, HP/IZ3

Includes:

- 1 - Lock assembly with faceplate, deadbolt, latch and shoot bolts
- 11 (13 on 8/0) - #8 x 1 1/2" Phillips flat head stainless steel screws
- 2 - #8-15 x 2 1/2" Type AT/F, 2/3 thread, stainless steel screws

Usage dates:

03/2007 to present

CN	Color	PN
6-5	Stainless Steel	11891300
6-8		11891301
7-0		11891302
8-0		11891303



Special Size Active Multi-Point, HP/IZ3

Includes:

- 1 - Lock assembly with faceplate, deadbolt, latch and lower shoot bolts
- 1 - Top shoot bolt extension
- 12 - #8 x 1 1/2" Phillips flat head stainless steel screws
- 2 - #8-15 x 2 1/2" Type AT/F, 2/3 thread, stainless steel screws

Usage dates:

03/2007 to present

NOTE: ETO order required for special size doors. Rough opening, jamb depth, and door manufacture date required to provide correct component.

Color	PN
Stainless Steel	11861999

Inactive Multi-Point, HP/IZ3

Includes:

- 1 - Lock assembly with faceplate and shoot bolts
- 11 (13 on 8/0) - #8 x 1 1/2" Phillips flat head stainless steel screws

Usage dates:

03/2007 to present

CN	Color	PN
6-5	Stainless Steel	11891304
6-8		11891305
7-0		11891306
8-0		11891307

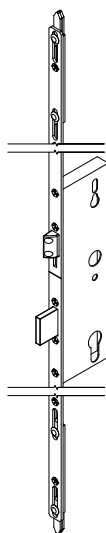

Special Size Inactive Multi-Point, HP/IZ3

Includes:

- 1 - Lock assembly with faceplate and lower shoot bolts
- 1 - Top shoot bolt extension
- 12 - #8 x 1 1/2" Phillips flat head stainless steel screws

Usage dates:

03/2007 to present

NOTE: ETO order required for special size doors. Rough opening, jamb depth, and door manufacture date required to provide correct component.

Color	PN
Stainless Steel	11891899

Multi-Point Lockbox, Active

PN
11896707

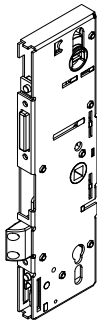

Multi-Point Lockbox, Passive

PN
11896708

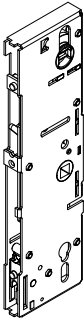

Stationary Lock Bar

PN	Suggested Fasteners	
11860366	Uses:	EA PN
	2 - #8 x 2 1/2" Phillips pan head screw	11800648

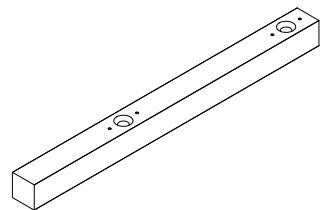

Twin Bolt Support Bracket

Color	PN	Suggested Fasteners	
Stainless Steel	11860477	Uses:	EA PN
		2 - #8 x 1" pan head screw	11805185

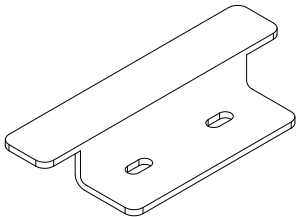

Stationary Bracket, Sill

PN	Suggested Fasteners	
11862595	Uses per bracket:	EA PN
	4 - #8 x 3/4" Phillips pan head screw	11805185

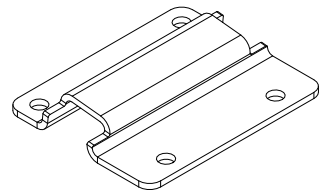

Stationary Bracket, Panel

PN	Suggested Fasteners	
11862662	Uses:	EA PN
	2 - #8 x 1 3/4" Phillips pan head screw	11808176

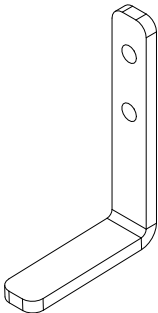

Strike Plate, Header, X

RH PN	LH PN
11862576	11862577

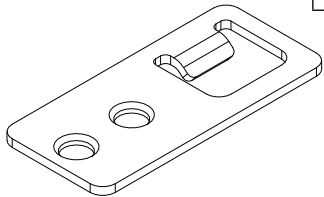

Suggested Fasteners	
Uses:	PN
2 - #8 x 5/8" Phillips Flat Head Screws	11805180

Strike Plate, Header, XX

PN
11862574

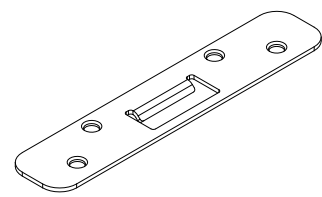

Suggested Fasteners	
Uses:	PN
2 - #8 x 5/8" Phillips Flat Head Screws	11805180
2 - #8 x 2 1/2" Phillips Flat Head Screws	11800648

Strike Plate, Stationary Lock Bar, XO/OX

PN
11862604

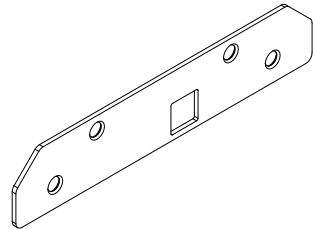

Suggested Fasteners	
Uses:	PN
2 - #8 x 5/8" Phillips Flat Head Screws	11805180
2 - #8 x 2 1/2" Phillips Flat Head Screws	11800648

Strike Plate, Meeting, XO

RH PN	LH PN
11862636	11862637

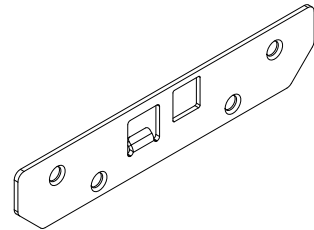

Suggested Fasteners	
Uses:	PN
2 - #8 x 5/8" Phillips Flat Head Screws	11805180
2 - #8 x 2 1/2" Phillips Flat Head Screws	11800648

Sill Strike, X

NOTE: If replacing a sill strike, 1 Gasket is needed

Color	LH PN	RH PN
Beige	11862591	11862596
Black	11862592	11862597

Suggested Fasteners	
Uses/Color	EA PN
1 - #8-15 x 3/4" Type A/Tek-2, Full Thread Screw	
Ebony	11800247
Cashmere	11800246

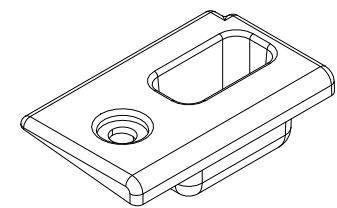

Gasket, Sill Strike, X

PN
10500621

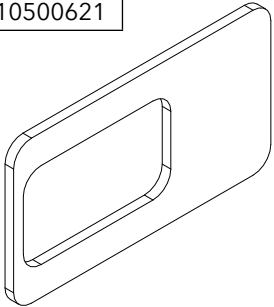

Sill Strike, XX

NOTE: If replacing a sill strike, 2 Gaskets are needed

Color	PN
Beige	11860548
Black	11860549

Suggested Fasteners	
Uses/Color	EA PN
2 - #8-15 x 3/4" Type A/Tek-2, Full Thread Screw	
Ebony	11800247
Cashmere	11800246

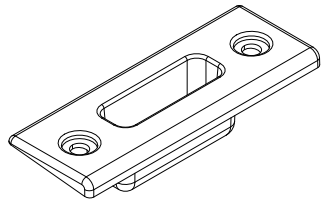

Gasket, Sill Strike, XX

PN
10500619

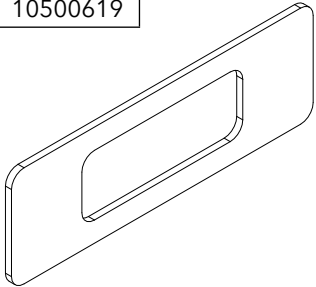

Strike Plate, Locking Jamb

Includes:

- 1 - Jamb strike plate
- 2 - #8 x 5/8" Phillips flat head screws
(Stainless Steel 11805180, Brass 11800580)
- 1 - #8 x 2 1/2" Phillips flat head screws
(Stainless Steel 11800648, Brass 11805165)

Configuration	Color	PN
X-R	Stainless Steel	11896674
	Brass	11896676
X-L	Stainless Steel	11896675
	Brass	11896677

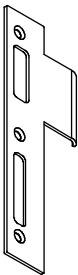

X-R shown

Strike Plate, Secondary Lock

Configuration	Color	PN
XX-R	Stainless Steel	11896560
	Brass	11860187
XX-L	Stainless Steel	11896559
	Brass	11860186

Suggested Fasteners	Color	PN
1 - 4mm x 16mm Torx flat head machine screw	Stainless Steel	11805183
1 - 4mm x 8mm Torx flat head machine screw	Stainless Steel	11805181
1 - 4mm x 35mm Torx flat head machine screw	Stainless Steel	11805184



XX-R shown

Secondary Lock Strike Plate

Color	Handing	PN
Stainless Steel	LH	11862525
	RH	11862526
Brass	LH	11862515
	RH	11862516

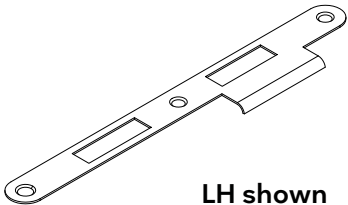

LH shown

Suggested Fasteners	Color	PN
1 - 4mm x 16mm Torx flat head machine screw	Stainless Steel	11805183
1 - 4mm x 8mm Torx flat head machine screw	Stainless Steel	11805181
1 - 4mm x 35mm Torx flat head machine screw	Stainless Steel	11805184

Top Shoot Bolt Guide

LH PN	RH PN
11862642	11862641

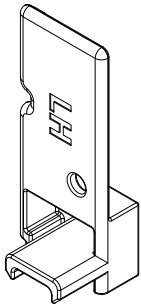

Bolt Plug, Locking Jamb

Color	PN
Black	11862552

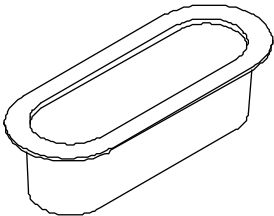

Latch Plug, Locking Jamb

Color	PN
Black	11862553

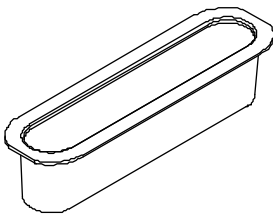

Stationary Panel Clip

Includes:

- 1 - Stationary panel clip
- 2 - Rivets (11800113)

Color	PN
Black	11896680

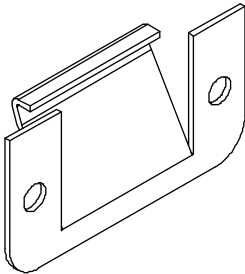

Stationary Panel Clip - OO

Includes:

- 1 - Stationary panel clip
- 2 - #8 x 1" Phillips, pan head, type A, stainless steel screws

Color	PN
Black	10888165

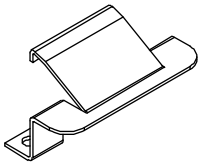

Sill Drain Weep

Color	PN
Black	15631215

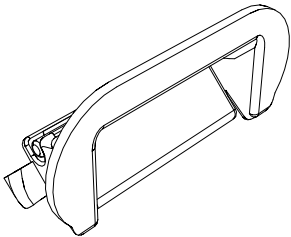

Sill Retainer, Stationary

Color	PN
Black	11862594

Suggested Fasteners	
Uses/Color	EA PN
5 - #8-15 x 3/4" Type A/Tek-2, Full Thread Screw	
Ebony	11800247

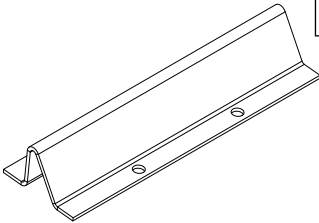

Eurogroove Block

V1407

NOTE: For Inswing and Outswing French Door Vertical Mull Kit

Color	PN
Beige	11860111

Suggested Fasteners	
Uses	EA PN
2 - #8-18 x 1" Type AB, Truss Head, Full Thread Screw	11800867

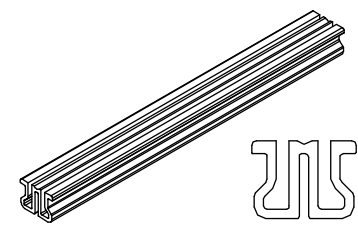

Jamb Weather Strip Plug

PN
10500292

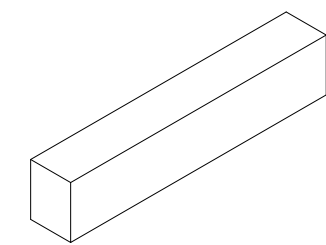

Stationary Panel Bracket

PN
11862520

Suggested Fasteners	
Uses	EA PN
2 - #8-18 x 1" Type AB, Truss Head, Full Thread Screw	11800867
2 - #8-5/32 x 1/2" Type AB, Flat Head, Full Thread Screw	11800878

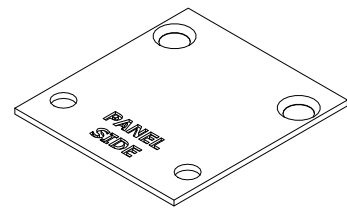

Dust Block

Color	PN
Black	15600009

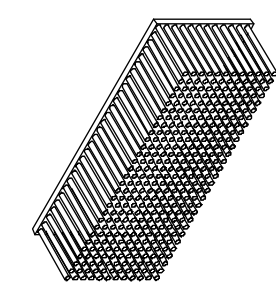

Installation Bracket Sill, HP/IZ3

PN
11860102

Suggested Fasteners	
Uses	EA PN
1 - #10 x 2 3/4" Flat Head, 2/3 Thread, Masonry Anchor	11800869

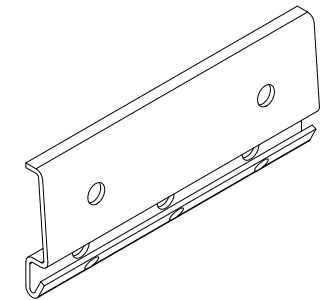

Dust Block, L Shape

Color	PN
Black	15600035

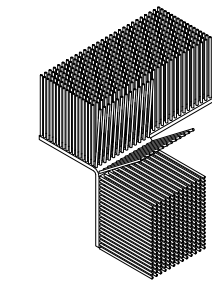

#8 x 5/8” Phillips Flat Head Screw

Color	PN EA
Stainless Steel	11805180
Painted Gold	11805159
Painted Silver	11805158
Brass	11805153
Stone White	11805155
Dark Brown	11805156
Pebble	11805157
Cashmere	11805146
Almond Frost	11885156

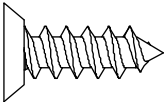

#8 x 2 1/2” Flat Head Screw

Color	PN EA
Stainless Steel	11800648
Painted Gold	11805161
Painted Silver	11805162
Brass	11805165
Stone White	11805163
Dark Brown	11805164
Pebble	11805175
Cashmere	11805147
Almond Frost	11885164

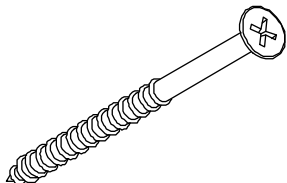

#8 x 5/8” ” Pan Head Screw,
Self-drilling/Tapping

Color	PN
Stainless Steel	11800498

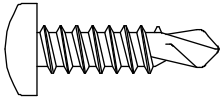

#8-18 x 1” Type A/Tek-2 Screw

PN
11800229

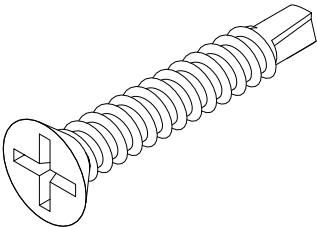

#8-18 x .547” AB Tek,
Cross Recessed Pan Screw

PN
11800485

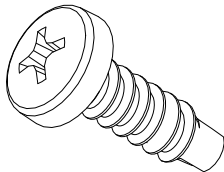

#8-15 x 3/4” Type A/Tek-2, Full Thread Screw

Color	PN
Ebony	11800247
Cashmere	11800246

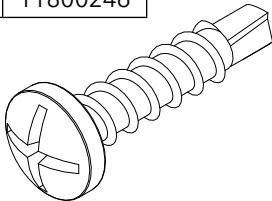

#8 x 2 1/2” Phillips Truss Head Screw

Color	PN
Stainless Steel	11805151

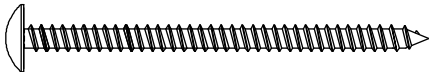

#8-18 x 1 3/4” Full Thread, Pan Head Screw

PN
11808176

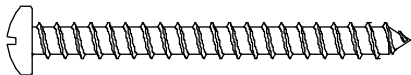

#8 x 2” Phillips Flat Head Screw

Color	PN
ZYD	11800868



#8 x 1 1/4” Phillips Flat Head
2/3 Thread Screw

Color	PN
ZYD	11805179

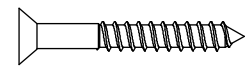

#8 x 5/8” Phillips Flat Head Screw

Color	PN EA
Stone White	11800850

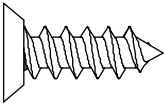

#8 x 1” Pan Head Screw

Color	PN EA
Stainless Steel	11805185

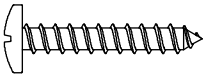

4mm x 8mm TORX Flat
Head Machine Screw

Color	PN EA
Stainless Steel	11805181

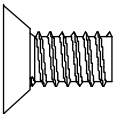

4mm x 16mm TORX Flat
Head Machine Screw

Color	PN EA
Stainless Steel	11805183

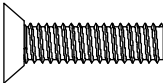

4mm x 35mm TORX Flat
Head Machine Screw

Color	PN EA
Stainless Steel	11805184

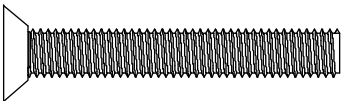

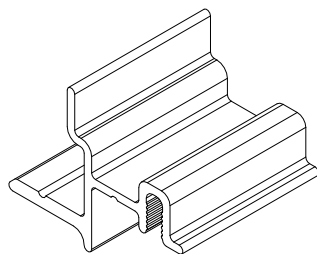

**Astragal Base, Exterior
A1432**

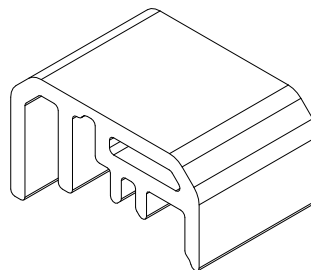

**Astragal Cap, Exterior
A1464**

Stationary Jamb Retainer

V2547

Length	Color	PN
12" (305)	Black	15916812

Suggested Fasteners	
Uses/Color	EA PN
3 - #8-18 x 1" Type A/Tek-2 Screw	
Ebony	11800229

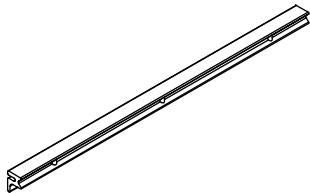

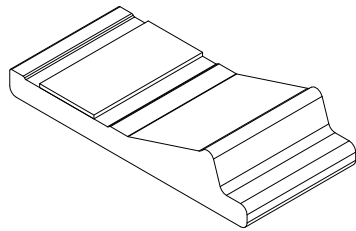

**Sill Liner, HP/IZ3
V03481**

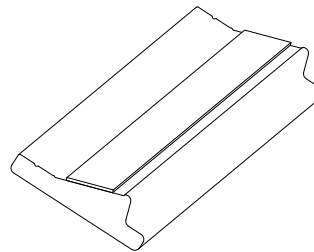

**Sill Liner w/tape applied
V03375**

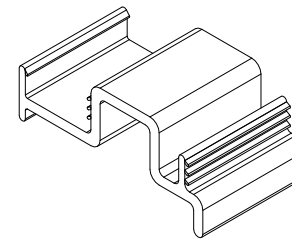

**Panel Sweep
V03376**

Panel Stop, Jamb

Includes:

- 1 - Panel Stop
- 1 - Connecting Barb
- 1 - Weather Strip
- 1 - Dust Block

CN	White	Clear Lacquer	Designer Black	Bare
6-5	11906965	11906865	11907065	11906765
6-8	11906968	11906868	11907068	11906968
7-0	11906970	11906870	11907070	11906770
8-0	11906980	11906890	11907080	11906780

IZ3 and HP				
CN	White	Clear Lacquer	Designer Black	Bare
6-5	11885865	11885765	11885965	11885565
6-8	11885868	11885768	11885968	11885568
7-0	11885870	11885770	11885970	11885570
8-0	11885880	11885780	11885980	11885580

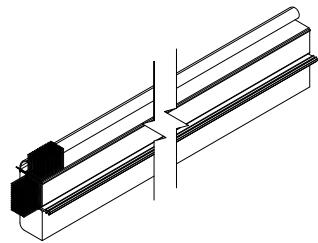

Panel Stop, Head Jamb

Includes:

- 1 - Panel Stop
- 1 - Connecting Barb
- 1 - Weather Strip

CN	White	Clear Lacquer	Designer Black	Bare
2-6	11906672	11886930	11890630	11906630
2-8	11906692	11886990	11890690	11906690
3-0	11906673	11886931	11890671	11906671
5-0	11907450	11907150	11909450	11909350
5-4	11907454	11907154	11909454	11909354
6-0	11907460	11907160	11909460	11909360
7-6	11907476	11907176	11909476	11909376
8-0	11907480	11907180	11909480	11909380
9-0	11907490	11907190	11909490	11909390

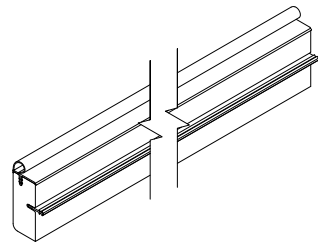

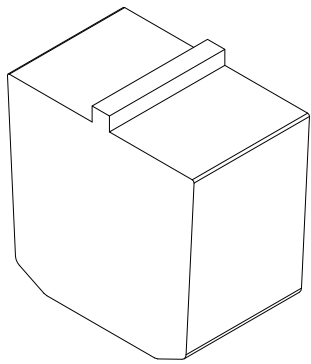

**Astragal Base, HP/IZ3,Interior
W14578**

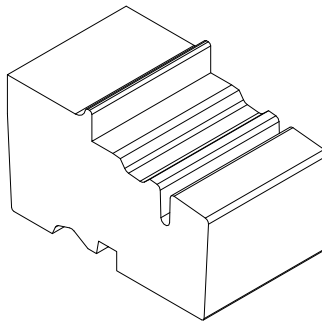

**Astragal Base, Interior
W14383**

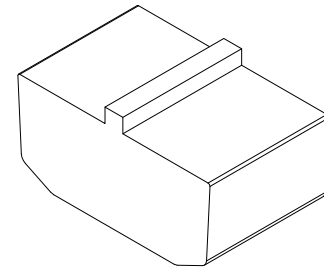

**Astragal Cap, Interior
W14384**

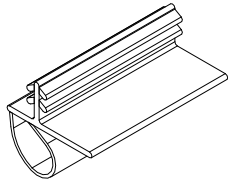

**Astragal Weather Strip, Exterior
V2800**

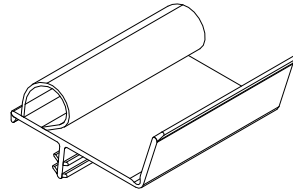

**Astragal Weather Strip, Interior
V03386**

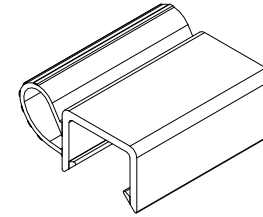

**Sill Weather Strip
V2026**

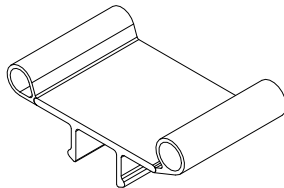

**Eurogroove Panel/
Top Rail Panel Weather Strip
V03410**

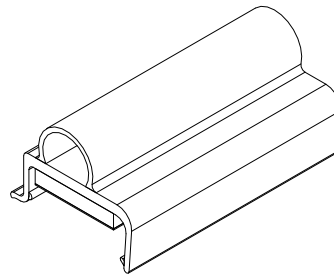

**Locking/Stat Panel Weather Strip
V1556**